

OCEAN CITY REEL No. 2000
(Model B)

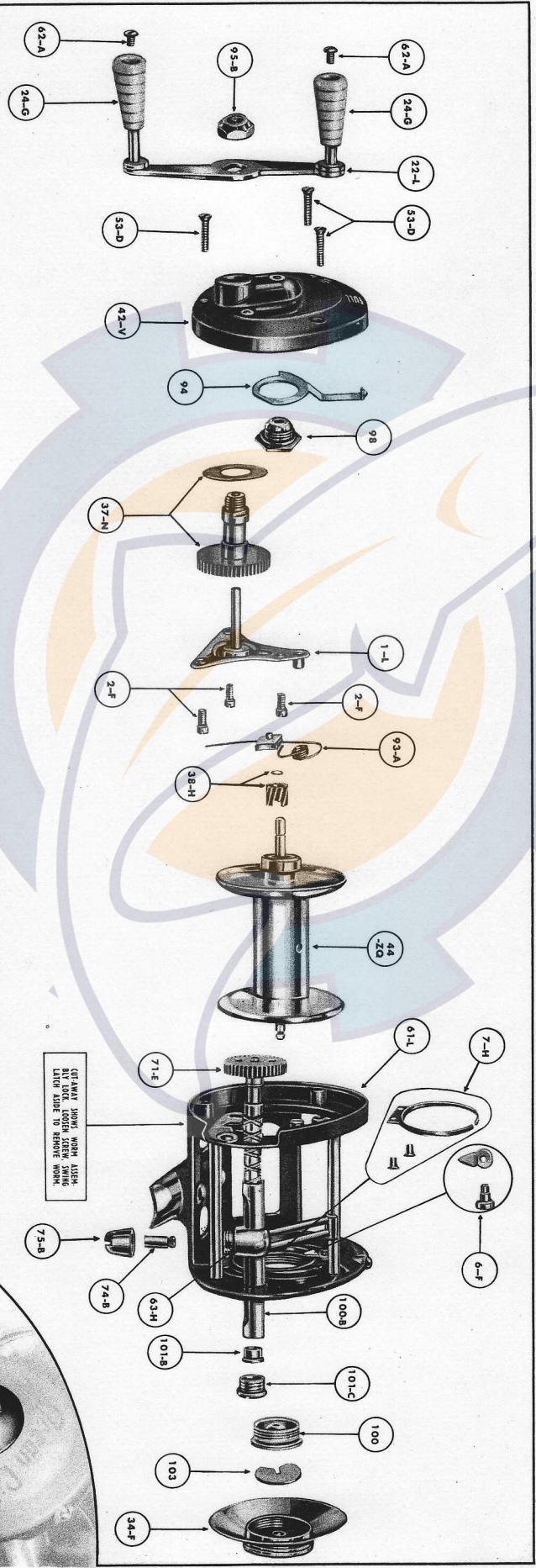

HOW TO ORDER PARTS FOR YOUR REEL—Locate the part desired in the illustration above and note part number. When ordering, state quantity, part number, part name and model letter which you will find on underside of reel stand. Enclose money order, stamps or check. Our minimum charge for one order is \$.25; please add \$.15 on each order for return postage and insurance.

PART NO.	PART NAME	PRICE	PART NO.	PART NAME	PRICE	PART NO.	PART NAME	PRICE
1—L	Bridge	.75	42—V	Right Side Plate	2.50	93—A	Drag Spring	.50
2—F	Bridge Screw	.02	44—ZQ	Spool	3.50	94	Drag Lever	.30
6—F	Click Pawl and Rivet	.15	53—D	Right Side Plate Screw	.02	95—B	Handle Nut	.12
7—H	Click Spring and Rivets	.10	61—L	Frame (Including Part Nos. 6-F and 7-H)	7.50	98	Right Side Bearing	.30
22—L	Handle, complete with knobs	1.00	62—A	Handle Knob Screw	.02	100	Left Side Bearing	.30
24—G	Handle Knob	.15	63—H	Line Guide	.60	100—B	Worm Guard	.25
34—F	Left Side Oil Cap	.60	71—E	Worm	1.50	101—B	Left End Worm Bearing	.10
37—N	Main Gear complete with washer	1.50	74—B	Worm Pawl	.10	101—C	Left End Screw Bearing	.15
38—H	Pinion Gear and Lock Ring	.25	75—B	Worm Pawl Cap	.10	103	Spool Latch	.10

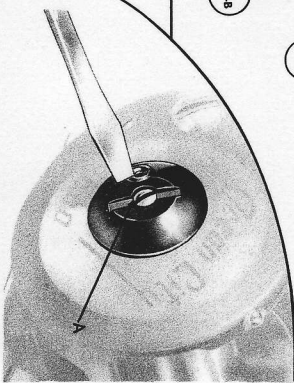

SPOOL ADJUSTMENT ON YOUR "2000" REEL
The spool on your OCEAN CITY No. 2000 reel was precisely adjusted for maximum casting efficiency when it left our factory. We suggest you do not alter this setting in any way. If you desire a greater amount of end play, when you find it necessary to feed the spool, you can do so very easily with the aid of a small screw driver. Just turn the small screw on the right end of the spool clockwise to the desired amount. Do NOT REMOVE ALL THE END PLAY. For best results always leave a little end play in the spool.